

Plant area  
 Area identified for potential PV array



Key:

- Application boundary
- Haul Road
- Top soil bund
- Extraction Areas
- Existing Vegetation (Trees & Hedgerows)
- Plant site area (Station Road)
- Proposed Planting
- Access Road
- Conveyor corridor
- Overburden
- Area of soil strip
- Spur conveyor
- Area of PV array

rev: | date: | details:

**corylus**  
 Planning &  
 Environmental Ltd.

The Old Dairy  
 Yanworth  
 Cheltenham  
 Gloucestershire  
 GL54 3LQ  
 tel: 01285 721072

client: **Raymond Brown**

project: **Hurst Farm & Station Road**

title: **Working Plan:  
 STAGE 7**

scale: 1:5000	date: 09/03/23	drawn by: JLB	checked by: AW	size: A3
---------------	----------------	---------------	----------------	----------

Project ref: 523	dwg no: HF/523/15-9	rev:
------------------	---------------------	------

Reproduced by permission of Ordnance Survey on behalf of HM SO. © Crown Copyright. All rights reserved. Licence No. 100045777. ALL LEVELS ABOVE ORDNANCE DATUM.

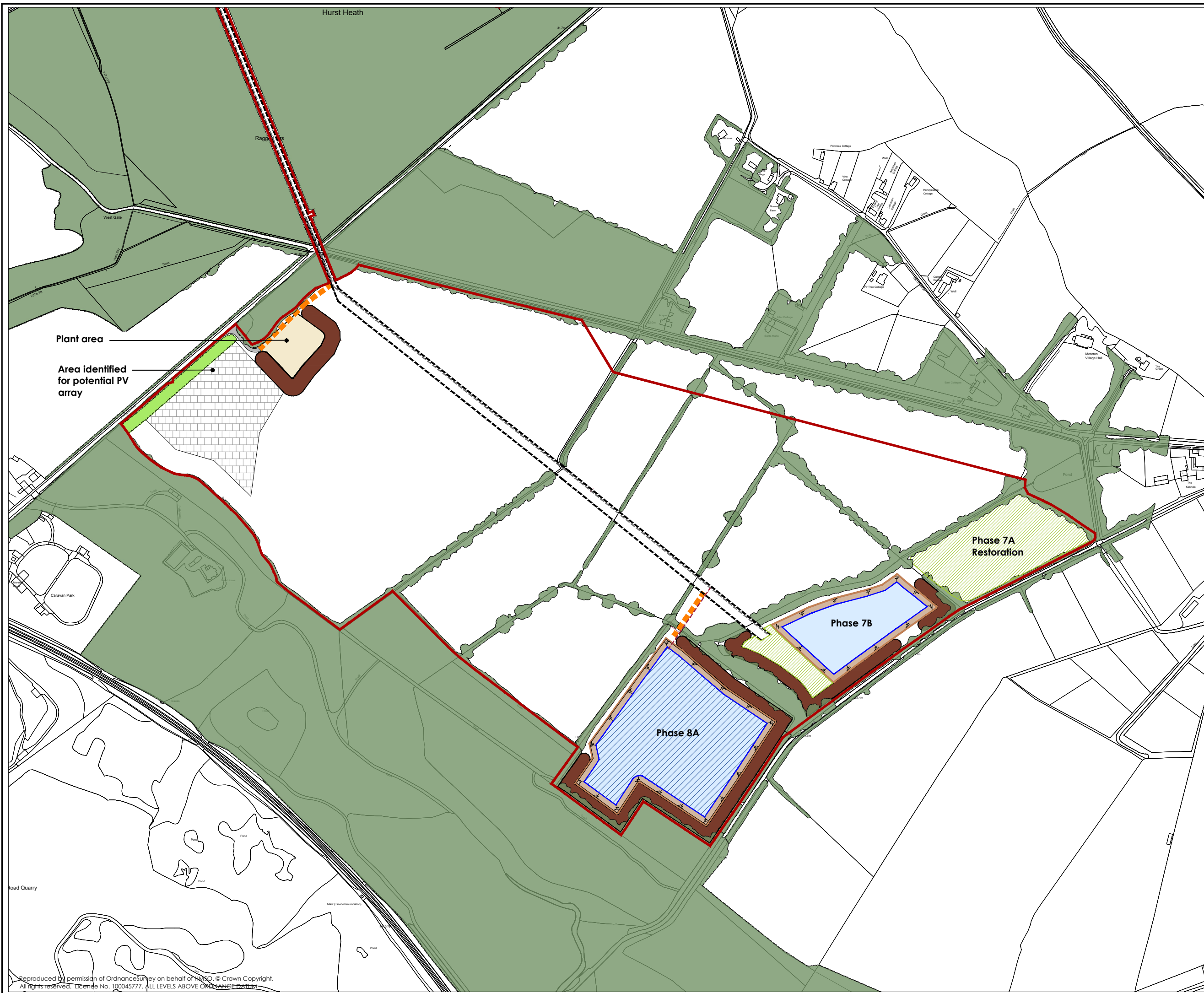

Key:

-  Application boundary
-  Haul Road
-  Top soil bund
-  Extraction Areas
-  Extraction areas (to be dredged)
-  Existing Vegetation (Trees & Hedgerows)
-  Plant site area (Station Road)
-  Proposed Planting
-  Access Road
-  Conveyor corridor
-  Area Backfilled for restoration
-  Spur conveyor
-  Area of PV array

rev: | date: | details:

 **corylus**  
 Planning & Environmental Ltd.  
 The Old Dairy  
 Yanworth  
 Cheltenham  
 Gloucestershire  
 GL54 3LQ  
 tel: 01285 721072

client:  
**Raymond Brown**

project:  
**Hurst Farm & Station Road**







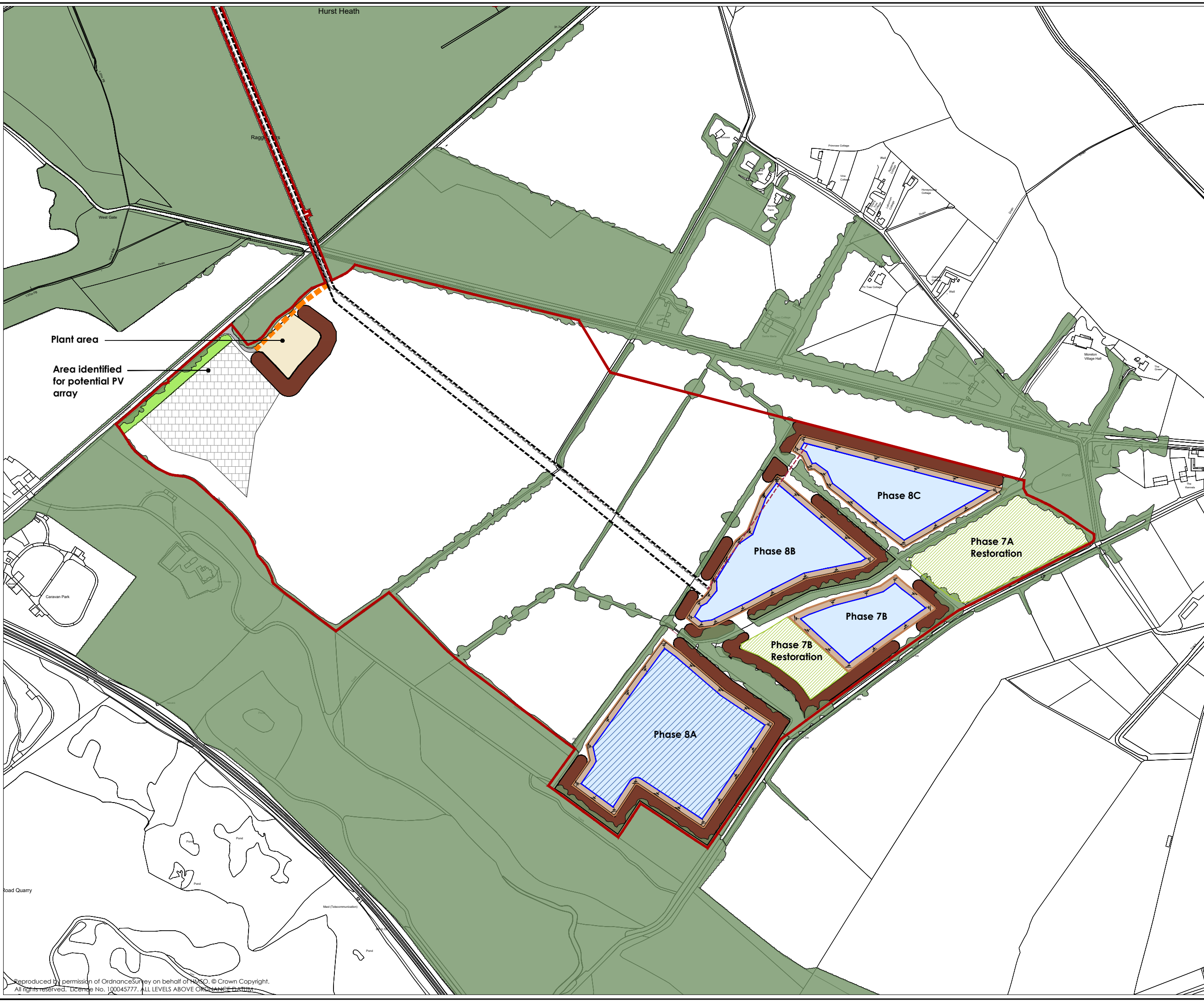





title:  
**Working Plan:  
 STAGE 8A**

scale: 1:5000	date: 13/03/23	drawn by: JLB	checked by: AW	size: A3
Project ref: 523	dwg no: HF/523/15-10	rev:		

Reproduced by permission of Ordnance Survey on behalf of HMSO. © Crown Copyright. All rights reserved. Licence No. 100045777. ALL LEVELS ABOVE ORDNANCE DATUM.



Key:

-  Application boundary
-  Haul Road
-  Top soil bund
-  Extraction Areas
-  Extraction areas (to be dredged)
-  Existing Vegetation (Trees & Hedgerows)
-  Plant site area (Station Road)
-  Proposed Planting
-  Access Road
-  Conveyor corridor
-  Area Backfilled for restoration
-  Spur conveyor
-  Area of PV array

rev: | date: | details:

 **corylus**  
 Planning & Environmental Ltd.  
 The Old Dairy  
 Yanworth  
 Cheltenham  
 Gloucestershire  
 GL54 3LQ  
 tel: 01285 721072

client: **Raymond Brown**

project: **Hurst Farm & Station Road**

title: **Working Plan:  
 STAGE'S 8B & C**

scale: 1:5000 | date: 13/03/23 | drawn by: JLB | checked by: AW | size: A3

Project ref: **523** | dwg no: **HF/523/15-11** | rev:

Reproduced by permission of Ordnance Survey on behalf of HM SO. © Crown Copyright. All rights reserved. Licence No. 100045777. ALL LEVELS ABOVE ORDNANCE DATUM.

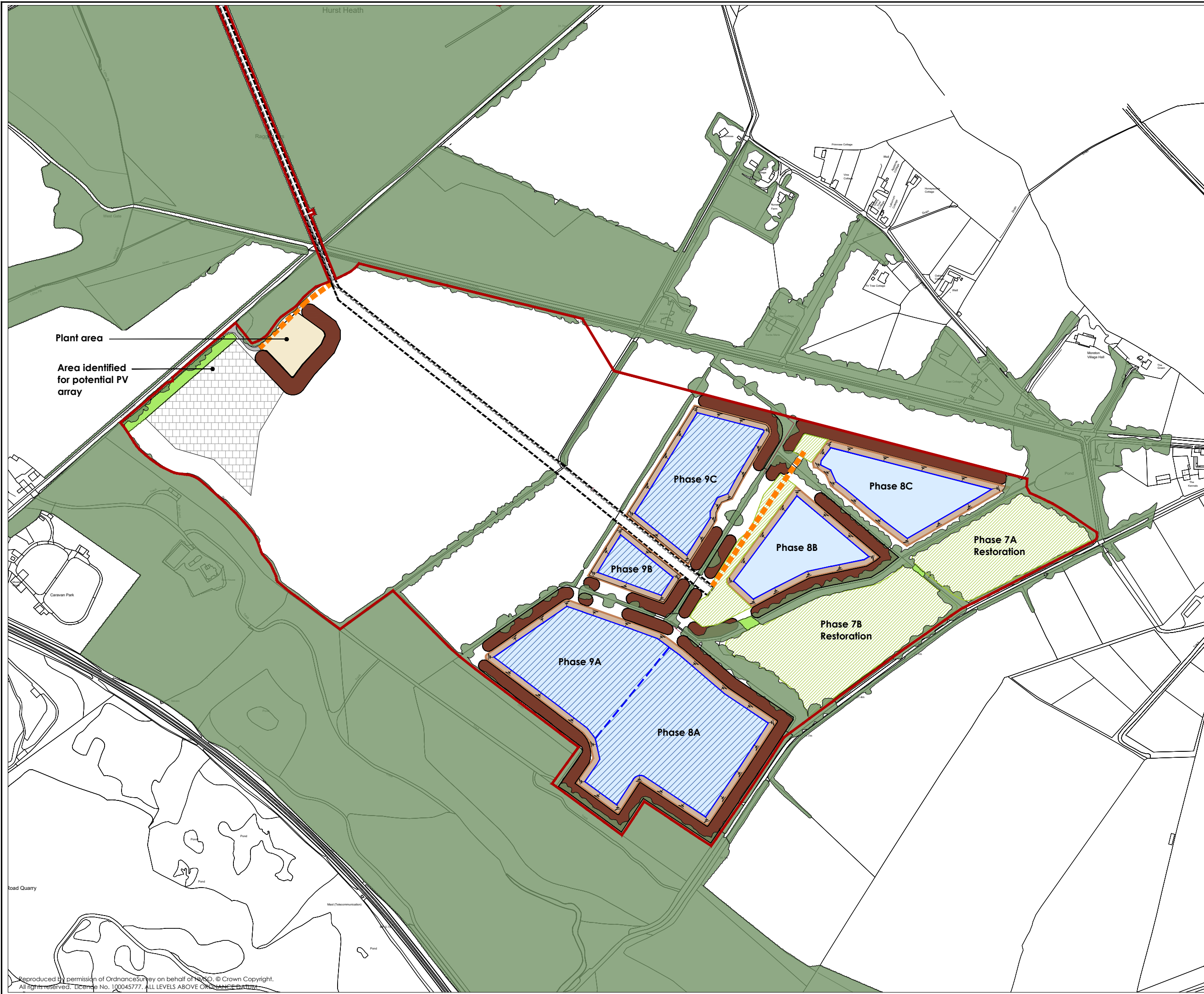

Key:

- Application boundary
- Haul Road
- Top soil bund
- Extraction Areas
- Extraction areas (to be dredged)
- Existing Vegetation (Trees & Hedgerows)
- Plant site area (Station Road)
- Proposed Planting
- Access Road
- Conveyor corridor
- Area Backfilled for restoration
- Spur conveyor
- Area of PV array

Plant area  
Area identified for potential PV array

<small>rev:</small>	<small>date:</small>	<small>details:</small>		
<span style="font-size: small; vertical-align: middle;">The Old Dairy Yarworth Cheltenham Gloucestershire GL54 3LQ tel: 01285 721072</span>				
<small>client:</small> Raymond Brown				
<small>project:</small> Hurst Farm & Station Road				
<small>title:</small> Working Plan: STAGE 9				
<small>scale:</small> 1:5000	<small>date:</small> 14/03/23	<small>drawn by:</small> JLB	<small>checked by:</small> AW	<small>size:</small> A3
<small>Project ref:</small> 523	<small>dwg no:</small> HF/523/15-12	<small>rev:</small>		

Reproduced by permission of Ordnance Survey on behalf of HM SO. © Crown Copyright. All rights reserved. Licence No. 100045777. ALL LEVELS ABOVE ORDNANCE DATUM.

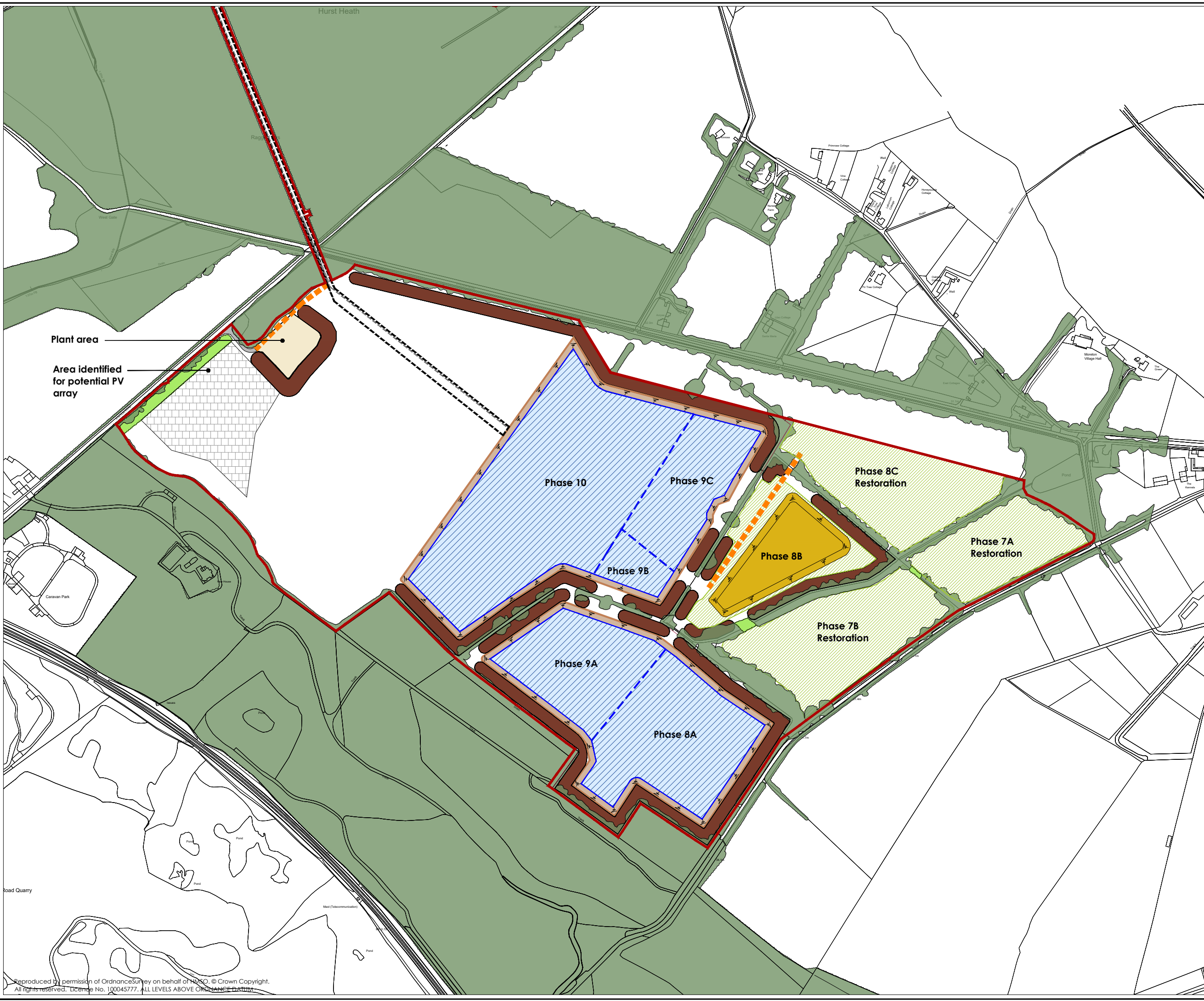

Key:

- Application boundary
- Haul Road
- Top soil bund
- Extraction Areas
- Extraction areas (to be dredged)
- Existing Vegetation (Trees & Hedgerows)
- Plant site area (Station Road)
- Proposed Planting
- Access Road
- Conveyor corridor
- Area Backfilled for restoration
- Spur conveyor
- Area of PV array
- Overburden

Plant area  
Area identified for potential PV array

<small>rev:</small>	<small>date:</small>	<small>details:</small>		
<span style="font-size: small; vertical-align: middle;">The Old Dairy Yanworth Cheltenham Gloucestershire GL54 3LQ tel: 01285 721072</span>				
<small>client:</small> Raymond Brown				
<small>project:</small> Hurst Farm & Station Road				
<small>title:</small> Working Plan: STAGE 10				
<small>scale:</small> 1:5000	<small>date:</small> 14/03/23	<small>drawn by:</small> JLB	<small>checked by:</small> AW	<small>size:</small> A3
<small>Project ref:</small> 523	<small>dwg no:</small> HF/523/15-13	<small>rev:</small>		

Reproduced by permission of Ordnance Survey on behalf of HM SO. © Crown Copyright. All rights reserved. Licence No. 100045777. ALL LEVELS ABOVE ORDNANCE DATUM.

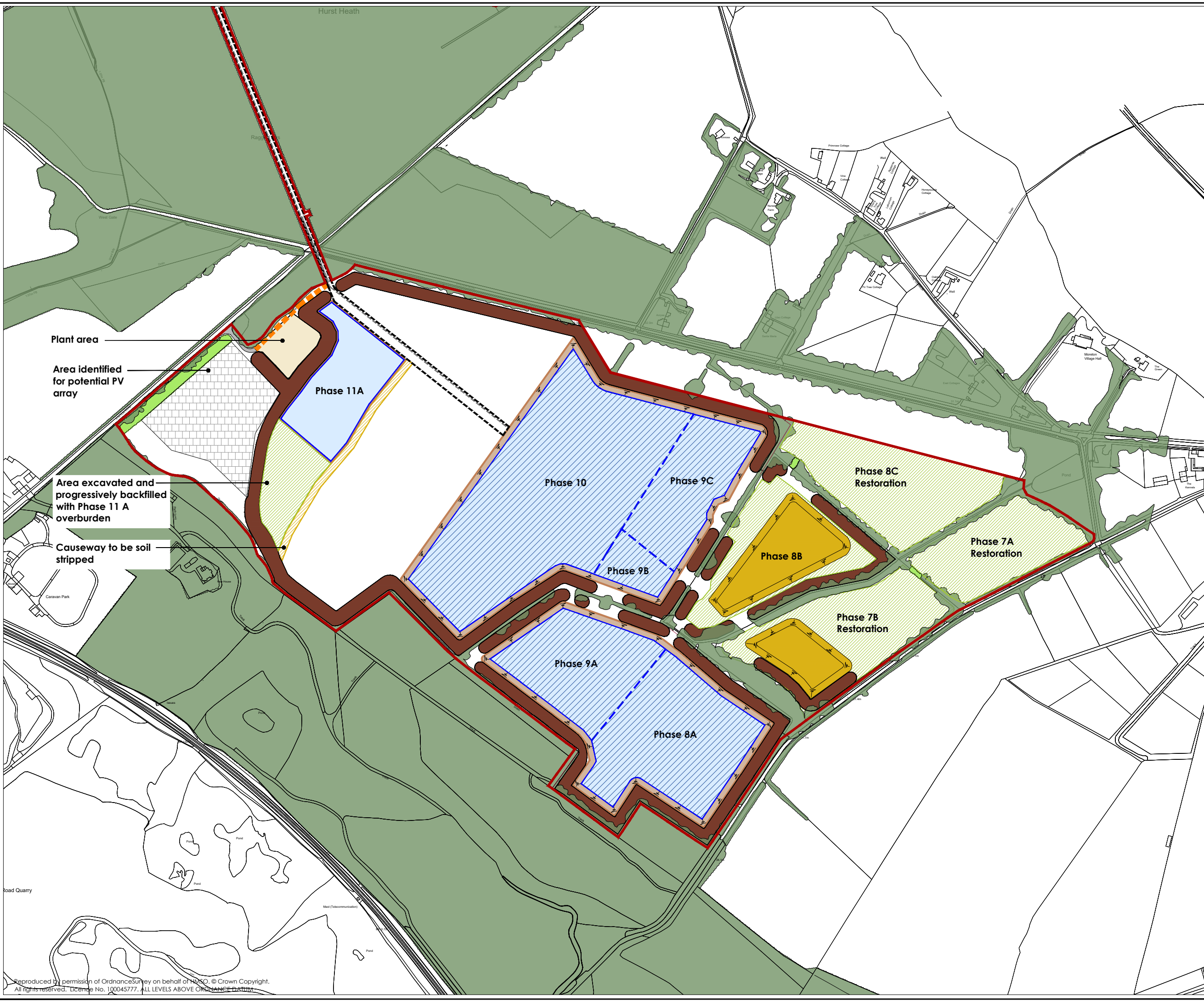

- Key:
- Application boundary
  - Haul Road
  - Top soil bund
  - Extraction Areas
  - Extraction areas (to be dredged)
  - Existing Vegetation (Trees & Hedgerows)
  - Plant site area (Station Road)
  - Proposed Planting
  - Access Road
  - Conveyor corridor
  - Area Backfilled for restoration
  - Spur conveyor
  - Area of PV array
  - Overburden
  - Area of soil strip

Plant area

Area identified for potential PV array

Area excavated and progressively backfilled with Phase 11 A overburden

Causeway to be soil stripped

Phase 11A

Phase 10

Phase 9C

Phase 8C Restoration

Phase 9B

Phase 8B

Phase 7A Restoration

Phase 9A

Phase 7B Restoration

Phase 8A

rev: A date: 03-04-23 details: (JLB) Station road offset updated



The Old Dairy  
Yanworth  
Cheltenham  
Gloucestershire  
GL54 3LQ  
tel: 01285 721072

client: Raymond Brown

project: Hurst Farm & Station Road

title: Working Plan:  
STAGE 11A

scale: 1:5000	date: 17/03/23	drawn by: JLB	checked by: AW	size: A3
---------------	----------------	---------------	----------------	----------

Project ref: 523	dwg no: HF/523/15-14	rev: A
------------------	----------------------	--------

Reproduced by permission of Ordnance Survey on behalf of HM SO. © Crown Copyright. All rights reserved. Licence No. 100045777. ALL LEVELS ABOVE ORDNANCE DATUM.

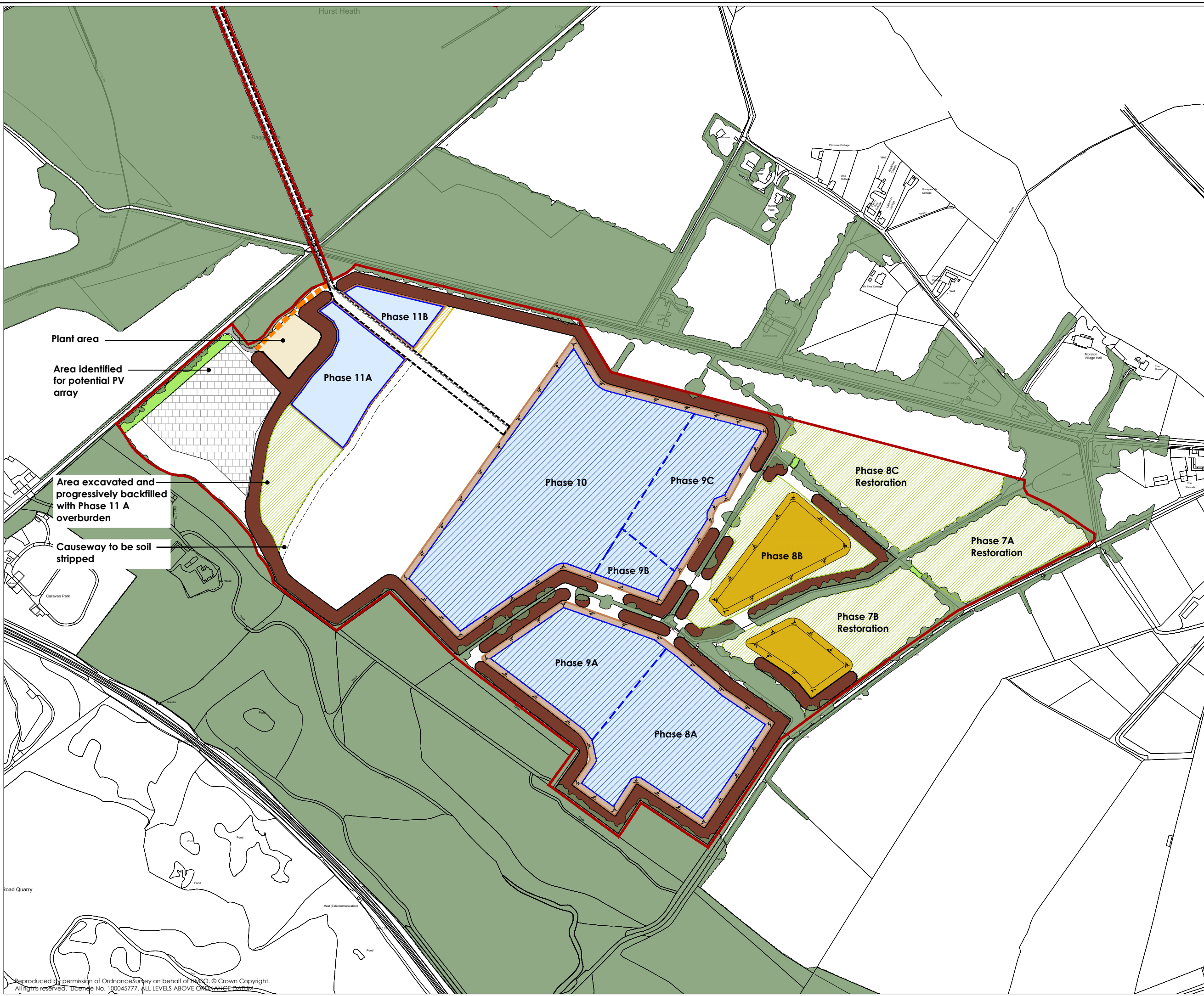

- Key:
- Application boundary
  - Haul Road
  - Top soil bund
  - Extraction Areas
  - Extraction areas (to be dredged)
  - Existing Vegetation (Trees & Hedgerows)
  - Plant site area (Station Road)
  - Proposed Planting
  - Access Road
  - Conveyor corridor
  - Area Backfilled for restoration
  - Spur conveyor
  - Area of PV array
  - Overburden
  - Area of soil strip

Plant area

Area identified for potential PV array

Area excavated and progressively backfilled with Phase 11 A overburden

Causeway to be soil stripped

Phase 11B

Phase 11A

Phase 10

Phase 9C

Phase 8C Restoration

Phase 9B

Phase 8B

Phase 7A Restoration

Phase 9A

Phase 7B Restoration

Phase 8A

rev: A | date: 03-04-23 | details: (JLB) Station road offset updated

**corylus**  
 Planning & Environmental Ltd.  
 The Old Dairy  
 Yanworth  
 Cheltenham  
 Gloucestershire  
 GL54 3LQ  
 tel: 01285 721072

client: Raymond Brown

project: Hurst Farm & Station Road

title: Working Plan:  
 STAGE 11B

scale: 1:5000	date: 17/03/23	drawn by: JLB	checked by: AW	size: A3
project ref: 523	dwg no: HF/523/15-15	rev: A		

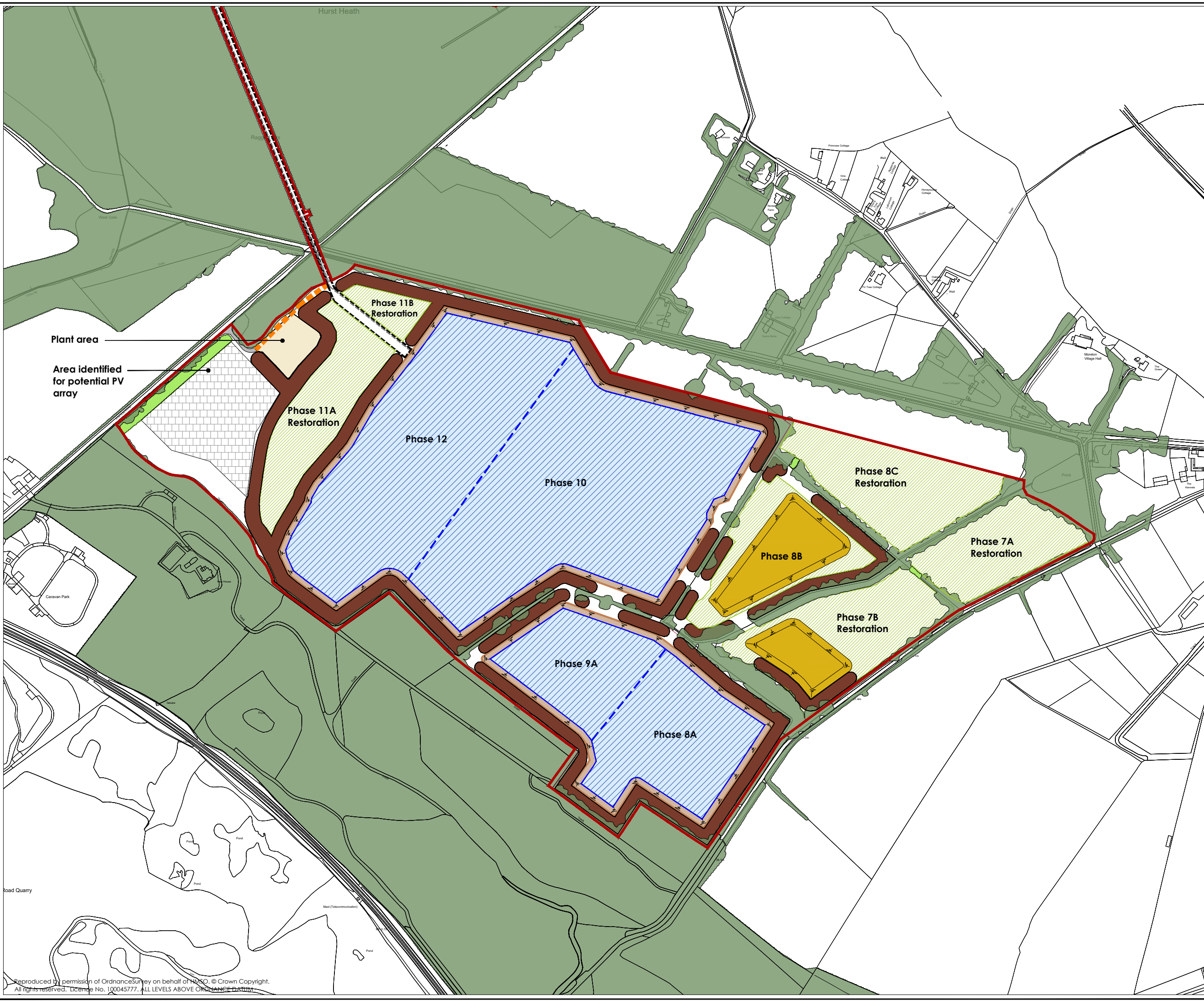

- Key:
- Application boundary
  - Haul Road
  - Top soil bund
  - Extraction Areas
  - Extraction areas (to be dredged)
  - Existing Vegetation (Trees & Hedgerows)
  - Plant site area (Station Road)
  - Proposed Planting
  - Access Road
  - Conveyor corridor
  - Area Backfilled for restoration
  - Spur conveyor
  - Area of PV array
  - Overburden

Plant area  
 Area identified for potential PV array

rev: A | date: 03-04-23 | details: (A&B) Station road offset updated

**corylus**  
 Planning & Environmental Ltd.  
 The Old Dairy  
 Yanworth  
 Cheltenham  
 Gloucestershire  
 GL54 3LQ  
 tel: 01285 721072

client: Raymond Brown

project: Hurst Farm & Station Road

title: Working Plan:  
 STAGE 12

scale: 1:5000	date: 17/03/23	drawn by: JLB	checked by: AW	size: A3
project ref: 523	dwg no: HF/523/15-16	rev: A		

Reproduced by permission of Ordnance Survey on behalf of HM SO. © Crown Copyright. All rights reserved. Licence No. 100045777. ALL LEVELS ABOVE ORDNANCE DATUM.